

无刷直行星齿轮减速电机 BLDC Planetary Gear Motor

36JX30K/36ZWN42

Φ36加强型减速器，允许转矩范围：0.3N.m~3.0N.m
36mm OD Reinforced Gearbox,
Permissible Load Range: 0.3N.m~3.0N.m

● 外形和安装尺寸 Dimensions

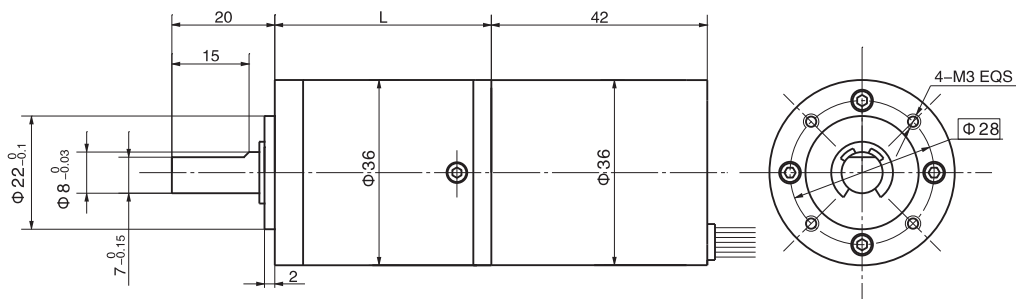

● 无刷电动机主要技术参数 Brushless Motor Technical Data

电机型号 Type	额定电压 Rated voltage VDC	空载转速 No-load speed r/min	空载电流 No-load current A	额定转速 Rated speed r/min	额定转矩 Rated torque mN.m	输出功率 Output power W	峰值力矩 Biggest torque mN.m
36ZWN42-2430	24	3000	0.27	2100	32	7	96
36ZWN42-2440	24	4000	0.30	2800	36	10	110

● 无刷行星齿轮减速电机主要技术参数 Brushless Gear Motor Technical Data

配置36ZWN42-2430无刷直流电机 (36ZWN42-2430 DC Motor)

减速比 Reduction ratio	3.7	5.2	14	19	27	51	71	100	139	189	264
减速级数 Number of gear trains	1	1	2	2	2	3	3	3	3	4	4
减速器长度(L) Length(L) mm	31.0	31.0	38.5	38.5	38.5	48.2	48.2	48.2	48.2	55.4	55.4
空载转速 No-load speed r/min	809	579	214	158	111	59	42	30	22	16	11
额定转速 Rated speed r/min	566	405	150	111	78	41	30	23	18	13	9
额定转矩 Rated torque N.m	0.09	0.13	0.31	0.42	0.59	1.0	1.4	2.0	2.5	3	3
最大瞬间允许负载 Max. permissible load in a short time N.m	1.0	1.0	3.5	3.5	3.5	7.5	7.5	7.5	7.5	9	9

配置36ZWN42-2440无刷直流电机 (36ZWN42-2440 DC Motor)

减速比 Reduction ratio	3.7	5.2	14	19	27	51	71	100	139	189	264
减速级数 Number of gear trains	1	1	2	2	2	3	3	3	3	4	4
减速器长度(L) Length(L) mm	31.0	31.0	38.5	38.5	38.5	48.2	48.2	48.2	48.2	55.4	55.4
空载转速 No-load speed r/min	1078	772	286	211	148	78	56	40	29	21	15
额定转速 Rated speed r/min	755	541	200	147	104	55	39	30	23	18	14
额定转矩 Rated torque N.m	0.10	0.14	0.34	0.46	0.66	1.1	1.6	2.2	2.5	3	3
最大瞬间允许负载 Max. permissible load in a short time N.m	1.0	1.0	3.5	3.5	3.5	7.5	7.5	7.5	7.5	9	9