

无刷直行星齿轮减速电机 BLDC Planetary Gear Motor

42JXT200K/42ZWN60

Φ42超大力矩型减速器, 允许转矩范围: 2N.m~20N.m
42mm OD Large Torque Gearbox, Permissible Load Range: 2N.m~20N.m

42JXGT200K/42ZWN60

Φ42长寿命、超大力矩型减速器, 允许转矩范围: 2N.m~20N.m
42mm OD Long Life & Large Torque Gearbox, Permissible Load Range: 2N.m~20N.m

外形和安装尺寸 Dimensions

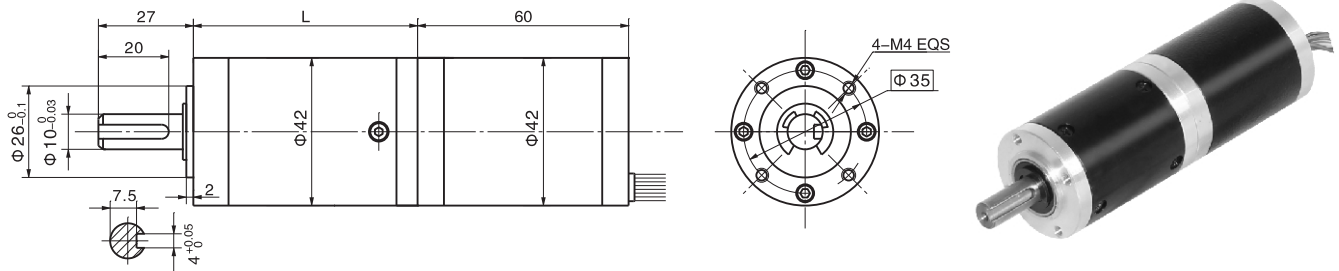

无刷电动机主要技术参数 Brushless Motor Technical Data

电机型号 Type	额定电压 Rated voltage VDC	空载转速 No-load speed r/min	空载电流 No-load current A	额定转速 Rated speed r/min	额定转矩 Rated torque N.m	额定电流 Rated current A	输出功率 Output power W	峰值力矩 Biggest torque N.m
42ZWN60-2430	24	3000	0.16	2100	0.06	1.1	13.0	0.18
42ZWN60-2440	24	4000	0.24	2800	0.07	1.6	20.5	0.23

无刷行星齿轮减速电机主要技术参数 Brushless Gear Motor Technical Data

配置42ZWN60-2430无刷直流电机 (42ZWN60-2430 BLDC Motor)

减速比 Reduction ratio	17	22	65	83	106	247	316	403	515
减速级数 Number of gear trains	2	2	3	3	3	4	4	4	4
减速器长度(L) Length(L) mm	49.5	49.5	59.9	59.9	59.9	70.3	70.3	70.3	70.3
空载转速 No-load speed r/min	176	136	46	36	28	12	9.5	7.4	5.8
额定转速 Rated speed r/min	124	95	32	25	20	85	6.6	5.2	4.1
额定转矩 Rated torque N.m	0.83	1.1	2.8	3.6	4.6	9.8	13	16	20
最大瞬间允许负载 Max. permissible load in a short time N.m	25	25	50	50	50	60	60	60	60

配置42ZWN60-2440无刷直流电机 (42ZWN60-2440 BLDC Motor)

减速比 Reduction ratio	17	22	65	83	106	247	316	403	515
减速级数 Number of gear trains	2	2	3	3	3	4	4	4	4
减速器长度(L) Length(L) mm	49.5	49.5	59.9	59.9	59.9	70.3	70.3	70.3	70.3
空载转速 No-load speed r/min	235	182	62	48	38	16	13	10	7.8
额定转速 Rated speed r/min	165	127	43	34	26	11	8.9	6.9	5.4
额定转矩 Rated torque N.m	0.96	1.3	3.3	4.2	5.4	11	15	19	20
最大瞬间允许负载 Max. permissible load in a short time N.m	25	25	50	50	50	60	60	60	60